

Parqwood installation instructions

You have chosen to acquire a BerryAlloc Parqwood, and we thank you for your trust. We are confident that your Parqwood will provide you with timeless pleasure due to the quality of its design. Moreover, throughout its production, your Parqwood has undergone numerous quality controls to perfect its assembly and ensure its longevity. Before fully appreciating all its qualities, we would like to remind you that: Our Parqwood is made of real wood, subject to variations in shade and the presence of knots, which are indeed part of the charm of a genuine natural floor. Depending on their origin and cutting, the planks may exhibit variations in tone, including in comparison to the reference sample.

Wood is a living material that evolves with the seasons. It is normal and natural for it to expand and contract in function on the temperature and humidity conditions in which it is used (for example, during heating periods).

Parqwood XL / Parqwood XXL Long

Class 23/33 Parqwood XL and Parqwood XXL Long floors are designed for:

- Heavy domestic use
- High commercial use

Parqwood floors are not suitable for conservatories, verandas, saunas, or outdoor use.

Before starting the installation of your Parqwood floor, carefully read this installation manual detailing the points related to the different types of installation. You will also find a summarised installation manual regarding installation specifics, substrate characteristics, storage, and on-site installation conditions in the Parqwood packages.



1. Plan your installation

The Parqwood has to be stored flat in the room where it will be installed, in their original packaging 48 hours before starting the installation. The packages will only be opened at the time of installation.

Installing Parqwood should be the last task performed on the site. The substrate must be perfectly dry, the windows installed, all structural and finishing work (plastering, tiling, painting, wallpapering, etc.) must be completed and dry. The room should be perfectly dry, closed, at an ambient temperature between 18 and 25°C, and the air humidity maintained constant between 40 and 65% with the ventilation system running throughout the duration of the project.

In some climates, such as in the Nordics during winter time, the RH level might drop far below 40% and in summertime rise above 65%. This will create a movement in your wood flooring. To secure enough clearance for this natural movement and to avoid open joints, squeaking, etc., always keep sufficient expansion gap at all points of the installation.

Package opening

- Wood is not a uniform material; each plank is unique.
- Handle the planks with care.
- Note the control number written on the end of the package or on the back of the first plank you will install. This number should be identical for all packages from the same project.
- Your Parqwood has undergone rigorous quality controls at every stage of its production. However, if an apparent defect has escaped the vigilance of these controls, do not install and contact your supplier/retailer for advice.

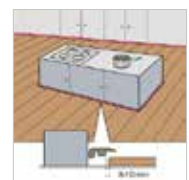
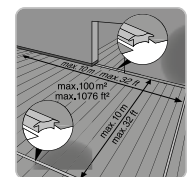
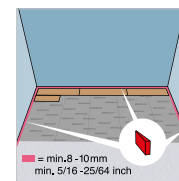
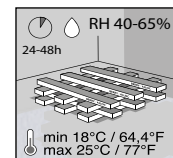

Tools

- Electric or manual saw
- Spacers
- A pull bar may be necessary for difficult situations
- Tape measure, pencil, square, bevel square

For your safety, use protective clothing: gloves, dust mask, safety glasses.

In addition to tools, do not forget the skirting boards and finishing profiles (doors, transitions to other spaces...) and the BerryAlloc underlayment according to your needs!



Type of installation: Floating or glue-down Installation?

Qualities	Floating (DTU N° 51.11 – French installation rule or other national rule)	Glue-down (DTU N° 51.2 – French installation rule or other national rule)
Ease of installation	Easy	Professional installation or by a good technician.
Time required to install (cost of labour)	Very quick installation	Quick installation thanks to BestLoc X-Treme
'Correctable'	Easy to correct	Installation is final
Removal	Easy and dust-free	Removal is technical and requires tools
Continuous surface	Max W 10 m x L 10 m	Unlimited
Expansion joint	Min 8 mm and 1.5 mm/m	Limited expansion at edges 5 mm to 8 mm
Squeaking	Risk if humidity is absorbed	No squeaking
Effectiveness with underfloor heating	Less effective (see conditions)	More effective
Resonance in the room	Improved with an ExcellencePlus underlay	Most silent
Noise transmission to room below	-19dB with ExcellencePlus underlay	High if no gluing on both sides with acoustic underlay

Parqwood flooring can be installed in a **floating installation** (according to DTU 51.11), which means the floor must be able to move freely:

- Do not screw or glue the planks to the substrate.
- Do not install fixed installations such as kitchen cabinets or built-in wardrobes on a floating floor.
- A necessary expansion gap of 0.15% multiplied by the size of the floor, never less than 8 mm, has to be left around the perimeter. This expansion gap has to be left along the walls, in front of and around any obstacles (pipes, stair bases, posts, fireplace bases, etc.).
- In all cases, this expansion gap is mandatory at each door opening of each room and will be concealed by a threshold profile.
- To allow free movement of the parquet, the width of the installed planks must not exceed 10 m. For larger dimensions, provide an intermediate expansion gap (called a fractionation joint), which will be concealed by a junction. Switch to glued installation to avoid threshold and fractionation profiles if these are not wanted for aesthetic reasons.

Parqwood flooring can be installed in **glue-down installation** (according to DTU 51.2), meaning the floor is completely bonded to the substrate:

- Use BerryAlloc adhesive (ref: 63003597).
- The adhesive will be applied with a notched trowel, in a maximum of 3 rows (provided with adhesive, consumption of approximately 1 kg/m² - refer to the adhesive manufacturer's instructions).
- Allow for an expansion gap around the perimeter of 5 to 8mm.
- After laying a complete row, press firmly to ensure good adhesion of the planks to the floor (with the adhesive still soft).
- To improve acoustic performance, it is possible to glue an intermediate underlay : typically a cork underlay or gluing the underlay to the substrate and then gluing the floor to this underlay.
- Glue-down installation should be used to avoid threshold bars and expansion joints and to allow installation without size limit.
- A glued installation will have a better heat transfer performance in the case of underfloor heating.

2. Prepare the substrate

Your Parqwood can be installed on the following types of substrate: fiber panels, particleboard panels, plywood panels, ceramic, cement screeds, compact PVC coatings, compact linoleum, tiles, old parquet floors, or old floorboards. Soft materials such as carpets must be removed.

For any other substrate, contact BerryAlloc support for advice. Parqwood installation must be carried out on a substrate that is rigid, pressure-resistant, and flexion-resistant. This substrate must be:

- **Clean:** Thoroughly clean the substrate surface to remove all residues and roughness from the old floor covering.
- **Level:** Check for flatness using a 2m rule; deviations (hollows or bumps) must be limited to 5mm under a 2m rule and less than 1mm under a 20cm rule. Sanding or leveling may be necessary if required.
- **Dry:** The moisture content of the cement screed or leveling compound must not exceed 3% using the calcium carbide method (on average, for normal screeds, allow at least 15 days per centimeter of thickness. For leveling compound, allow at least 5 days for 3 mm). For fluid calcium sulfate-based screeds, the residual moisture content must be less than or equal to 0.5%. For wooden subfloor, the maximum moisture content is 10%. For installation on concrete screed, it is strongly recommended to use a polyethylene film of at least 0.2 mm thickness to reduce potential moisture rising. This film (different from a vapour barrier, which is part of the underlay) is mandatory when the slab is in direct contact with the ground. This isolating film should be laid with a minimum overlap of 20 cm between strips and a minimum 3 cm upturn on the periphery (Note: This barrier is intended to prevent potential moisture rising. It does not constitute a completely waterproof barrier if moisture rises are significant). To improve acoustic comfort, the Parqwood flooring should be installed on an additional suitable underlay.
- **Healthy:** Remove dust or grease from the substrate. There can be no pulverisation, cracking, or crust on the surface.

We draw your attention to the fact that in general, Parqwood is not load-bearing.

3. Floor heating / cooling

If you have an underfloor heating system, be sure to read our separate manual for installing Parqwood on top of floor heating.

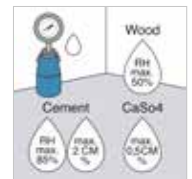
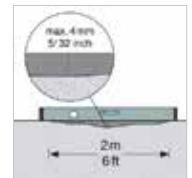
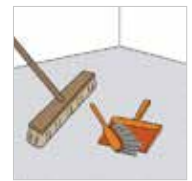

4. Underlays

The BerryAlloc ExcellencePlus underlay (SEPLUS10) is specifically designed for the floating installation of our Parqwood floors, ensuring a perfect result guarantee. Please refer to the underlay's technical datasheet for more information.

Tested, validated by FCBA, and compliant with standard NF B53-676 (Parquet underlay): low compressibility, stability under parqwood, and one of the most acoustically performant on the market.

For installation on concrete screed, it is strongly recommended to use a polyethylene film of at least 0.2 mm thickness to reduce potential moisture rising. This film (different from a vapor barrier) is mandatory when the slab is in direct contact with the ground (no crawl space). This insulation film should be laid with a minimum overlap of 20 cm between strips and a minimum 3 cm upturn on the periphery (Note: This barrier is intended to prevent potential moisture rises. It does not constitute a completely waterproof barrier if moisture rises are significant).

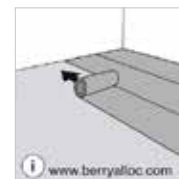

5. Getting started

Direction of the planks: the floor will look at its best if installed parallel to the incoming light (short side facing the light).

Measure the length of the room from the point where you plan to start the installation to the wall where you will end. Divide this by the width of a plank. The purpose is to never end with a plank that is less than 5 cm wide. If that is the case, you should modify the width of the first row (saw the plank so that you don't start with a full plank, but it should be more than 5 cm).

Check all planks for visible defects in optimal light conditions, both before and during installation. Planks with defects must not be used.

For the most natural floor pattern, open 3-4 packs and make sure to mix the designs of the planks across the floor.

The end joints should be staggered min. 1/3 of a plank when installing the floorboards.

The first and the last floorboard in each row should have a minimum length of 1/3 of a plank.

Start the first row with the tongue sides to the wall, and put the spacers for the expansion gap of 8-10 mm.

At the end of the row, to cut a plank in the exact length, put a plank on the reverse side against the wall – do not forget the expansion gap. Mark where the plank has to be cut and use a T-square to draw the cutting line.

If using a hand saw, cut on the pattern side, if using an electrical jigsaw, always cut on the back side of the plank.

A sharp saw blade is a must for the best result!

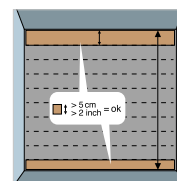

Parqwood installation instructions

6. A quick and easy installation

The BestLoc X-Treme system is extremely easy and fast, it allows you to install large planks with very little effort.

After you have installed the first row, in the second row all you have to do is lock the long side first, and then lower the plank into place on the short side, it will automatically lock, no other tool needed (ex. : mallet).

To install the last row, position a panel exactly on top of the previous row. Place another panel upside down up to the wall and mark the panel underneath. Cut the marked panel to size and fit in place.

This method should be repeated for each panel until the last row is complete.

Wooden doorframes should be shortened enough to accommodate a plank (and underlay).

Lay a panel face down next to the door frame. Saw the panel, then slide the plank under the door frame. Keep an expansion gap under the door frame of 8-10 mm!

If you have heating pipes or other fixed objects, measure their exact position and mark it on the Parqwood. Add 20 mm to the dimension of the pipe or the object, because the Parqwood has to be able to move in all directions around the pipe/object. Saw from the drilled holes to the side of the plank in an angle of 45° and put the plank in place.

If you want to unlock the BestLoc X-Treme system, unlock the long side of the row first and then slide the plank towards you without lifting it.

We remind you that any product installed is deemed accepted and may not give rise any subsequent claim

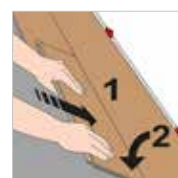
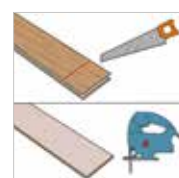
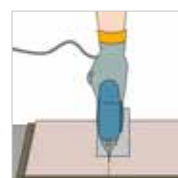
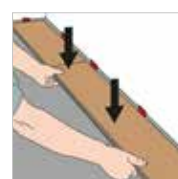
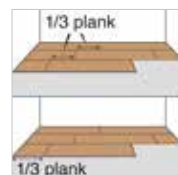

strong wood floors.

7. A perfect finish BerryAlloc offers a wide range of accessories with a timeless design for the finishing touch:

- Skirtings 69 mm;
- Expansion profiles: T-profile, threshold profile, end profile

Paintable white skirting and quarter rounds are also available and can be used unpainted, or they can be painted in the same colour as your wall.

When installing accessories on a floating floor, always keep in mind that the floor has to be able to move. This means:

- Skirtings should never be attached to the floor, they can be fixed to the wall with clips or in case your walls are not straight, use the BerryAlloc glue to glue the skirting to the wall.
- After you have installed a skirting or profile, do not seal/fix it to the Parqwood with sealant. The movement of the Parqwood will cause cracks in the sealing product which makes the sealant ineffective and unesthetic.
- Expansion joints around fixed building elements (door frames, heating pipes, etc.) should never be completely sealed with elastic filler.
- Profiles, door stops and other accessories cannot be screwed to the substrate through the floating floor.

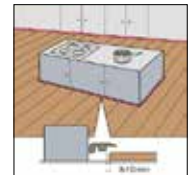
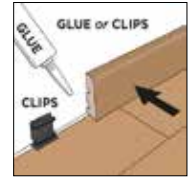

8. Care and maintenance

A Parqwood floor is very easy to clean:

- **DRY CLEANING:** with a brush, mop with dry wipes or vacuum cleaner
- **WET CLEANING:** with a well wrung-out cloth – avoid using too much water!

Clean up any spilled liquids immediately.

We strongly recommend to use the BerryAlloc cleaner (63002745), it's specially developed to clean our floors and leaves no traces.

Never use steam cleaners on Parqwood floors.

Put doormats at every entrance to protect your Parqwood from dirt and sand.

Lift heavy furniture and put felt pads on the legs of your chair. Use a protective floor mat under your castor chair.

Parqwood can not be polished or treated with products that contain wax or oil.

For more details: read our care and maintenance manual.



9. Warranty

By following the above mentioned instructions you will extend the longevity of your Parqwood flooring and ensure the validity of the warranty.

We refer to our warranty conditions or warranty policy for more info.

10. Installation video.

